

**16 BUTTON**

OCS-16W **16 Button Wall Unit**

OCS-16D **16 Button Desk Unit**  
Includes: Wall outlet (OCS-WJ) and 6 ft. cable

**24 BUTTON**

OCS-24W **24 Button Wall Unit**

OCS-24D **24 Button Desk Unit**  
Includes: Wall outlet (OCS-WJ) and 6 ft. cable

OCS-TL24W **24 Button Trimline Unit**  
designed for Cabinetry

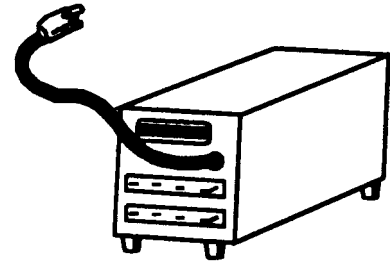

**POWER SUPPLY**

OCS-PS1 **Power Supply Unit**  
contains ON/OFF switch and 110 volt power plug  
**UL Approved**

NOTE: One power supply is needed for every 20 stations and/or 1000 feet of cable.

**POWER SUPPLY**

OCS-PS1 **Power Supply Unit**  
contains ON/OFF switch and 110 volt power plug  
**UL Approved**

NOTE: One power supply is needed for every 20 stations and/or 1000 feet of cable.

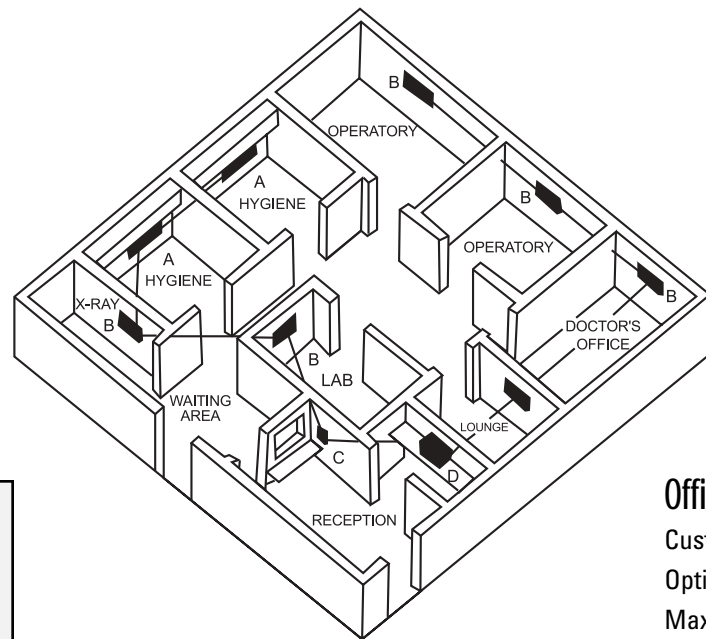
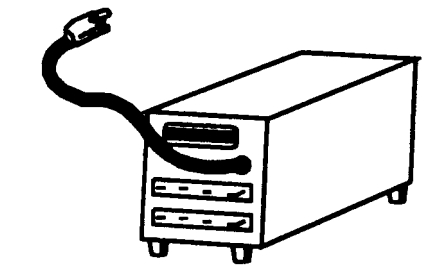

**Office Layout**

Custom buttons available  
Optional buttons available  
Maximum 20 units per system cable not to exceed 1000 ft.  
Any of the symbols may have a numeral added to them at no extra charge. Please allow 4 - 5 weeks for customized orders.

EXAMPLE: **AST 3**

**OCS OPTIONAL BUTTONS**

SYMBOL	DEFINITION
RCP	Receptionist
DR	Doctor
AST	Assistant
HYG	Hygienist
NO	Negative
YES	Affirmative
PAT	Patient
TEC	Technician
LAB	Laboratory
#0-#9	Numerals 0 - 9

**CABLE**

PV-100 **Round Cable w/PVC Jacket (100 feet)**  
Four conductor, 16 gauge, with ground wire shield

PV-250 **Round Cable w/PVC Jacket (250 feet)**  
Four conductor, 16 gauge, with ground wire shield

TF-100 **Round Cable w/Teflon Jacket (100 feet)**  
Four conductor, 16 gauge, with ground wire shield

TF-250 **Round Cable w/Teflon Jacket (250 feet)**  
Four conductor, 16 gauge, with ground wire shield

The average installation requires approximately 40 feet of cable per station. This amount will vary according to your specific installation.

OCS-MR **Pre-Installation "Bezel" for wall unit location in dry wall.**  
Provided at no charge when requested with complete OCS order.

NOTE: See Porter Instrument Brochure FM-634 for complete installation instructions.

SEE PAGE 13 FOR OCS OPTIONAL BUTTONS INFORMATION.

